

1 2 3 4 5 6 7 8

A

**Type 52FAAAA-AAAA**  
Udv. glat alu. / indv. glat alu.

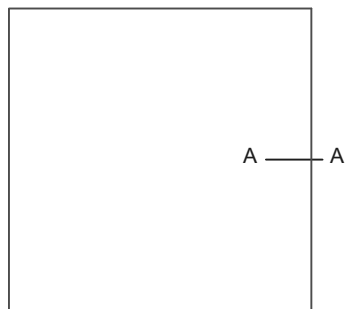

Snit A-A

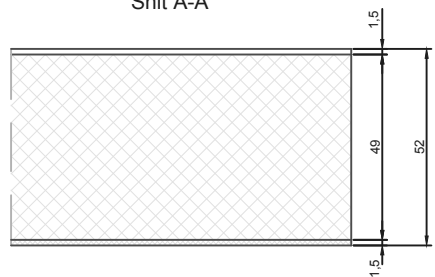

**Type 52FAAAA-HDAA**  
Udv. glat alu. / Indv. glat HDF

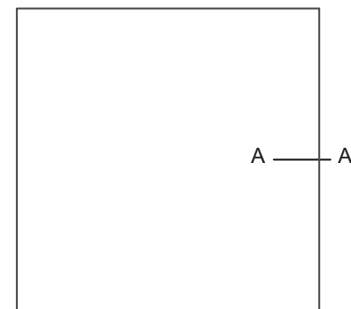

Snit A-A

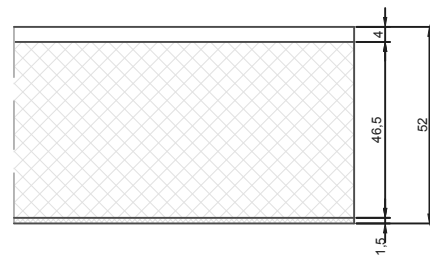

**Type 52FAAHC-AAAA**  
Udv. lodrette spor alu. / Indv glat alu.

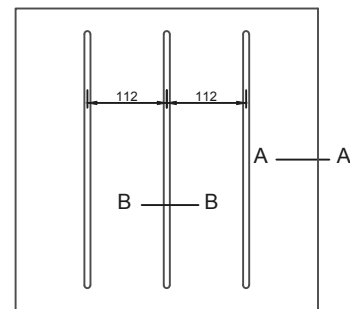

Snit B-B

Snit A-A

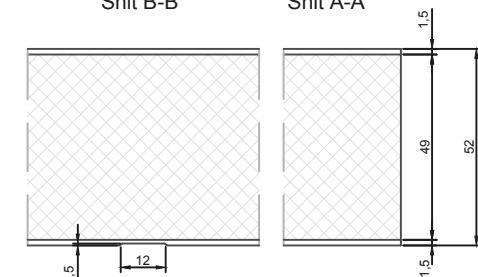

**Type 52FAAHC-HDAA**  
Udv. lodrette spor alu. / Indv. glat HDF

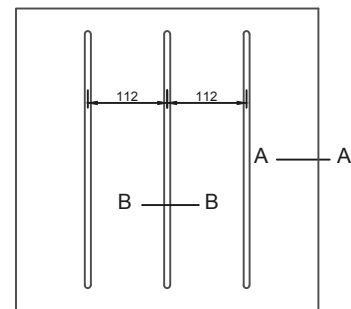

Snit B-B

Snit A-A

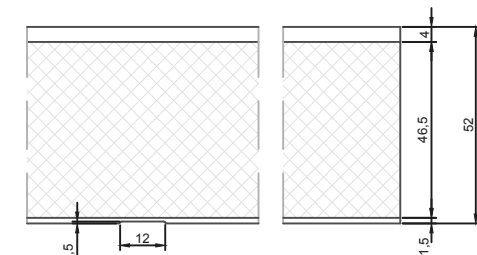

B

B

C

C

**Type 52FAAHJ-AAAA**  
Udv. vandrette spor alu. / Indv. glat alu.

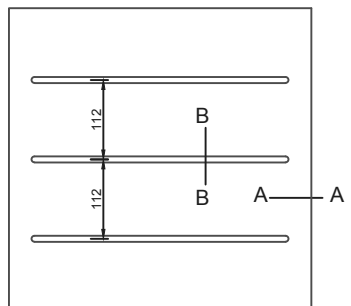

Snit B-B

Snit A-A

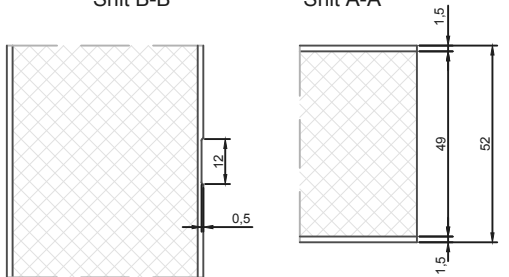

**Type 52FAAAA-IJSA**  
Udv. glat alu. / Indv. friset MDF T12

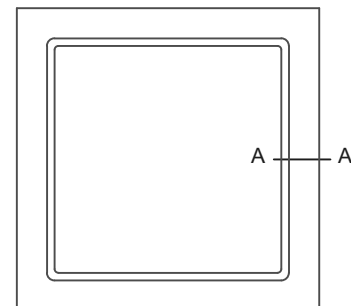

Snit A-A

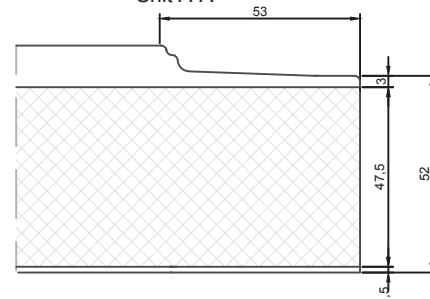

**Type 52FAANA-IJSA**  
Udv. friset alu. / Indv. friset MDF T12

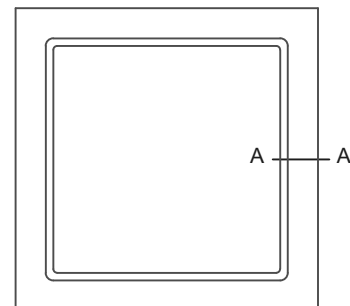

Snit A-A

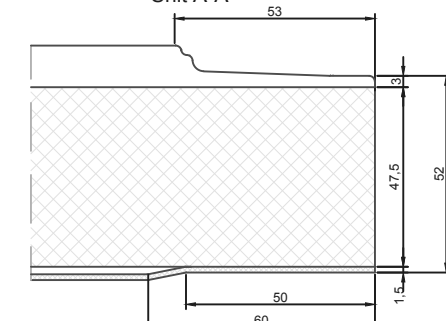

D

D

E

E

F

F

Profilkehling



Constr. by: <b>LM</b>	Rev. by:	Appr. by:	Tolerance: General Tolerance ±0.2
Constr. Date: 13/06/2022	Rev. date:	Appr. date:	Product series: NorDan NEO

Norwegian: Fyllingstyper  
NorDan NEO, 138 karm  
Danish: Fyldningstyper  
NorDan NEO, 138 karm  
English: Filling types  
NorDan NEO, 138 frame

**NorDan**  
www.nordanvinduer.dk

Format: A3	Scale: 1:2	Side: 1 of 1	Revision: A
Drawing no: 3FY-001			

This drawing is NorDan Vinduer AS property and may not without our permission be copied, transferred to another party or otherwise improperly used. Violation penalized under applicable law.

1 2 3 4 5 6 7 8